

Memory backup - Electrical ratings: 120V 15 Amp

Installation:

Plug the Smart Control into the outlet behind the refrigerator and plug the refrigerator into the receiving end of the cord.

The LED display is extended and mounted to the front or side of the refrigerator in a clearly visible location.

For a more secure installation see photos below:

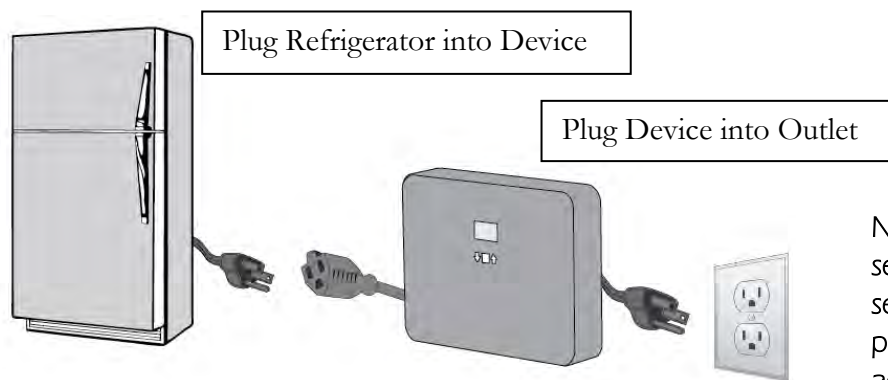
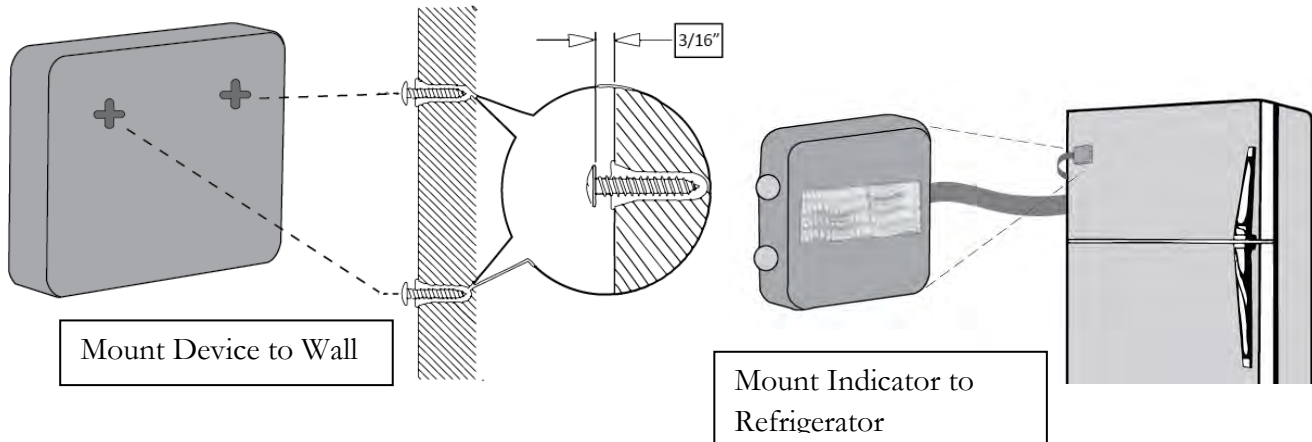

Note: Until the Smart control has been set with time date location and cycle setting, the refrigerator will remain powered on as normal without activating Shabbos/Yom tov Operation.

Settings:

When the Zman Refrigerator Smart Control starts up for the first time, the indicator lights and text on the display will flash. This flashing warns the user that the device needs setup.

Setting Time & Time Zone 🕒:

- Press the SET button once to power up the screen and once more to enter the main menu. The clock icon will be displayed.
- Press SET again to enter the Time menu. The hour will be highlighted
- Press the up/down arrows to select the hour and press the SET button to confirm the setting.
- The minute will now be highlighted..
- Use the arrows to scroll to the correct minute, and press SET.
- The screen will now display the time zones.
- Use the arrows to scroll to your applicable time zone and press SET.

Setting the date 📅:

After the time is set press the up arrow to enter the Date menu.

- Press SET again to set the date
- The year will be selected, press the up/down arrows to select the year. Press the SET button to confirm the selection and move on to the next item.

- Repeat the process for the month and day.

-Setting the location

- After the date is set press the up arrow to show the Location menu.
- Use the up/down arrows to select your state and press SET to confirm the selection.
- Use the up/down arrows to select your city and press SET to confirm the selection.

Latitude/Longitude Setting

Important : This is only needed if your city state is not on the list.

1) If your state or corresponding city is not on the list, continue scrolling using the arrows until Lat/Long is highlighted.

2) Press the SET button to enter Latitude/Longitude menu

3) Use the Up/Down arrows to set the value of the highlighted digit of your Latitude.

4) Press Menu/Set to move to the next digit.

5) Repeat steps 3 and 4 until latitude has been entered to two decimal places.

6) Press Menu/Set to save your latitude and move on to longitude.

7) Use the Up/Down arrows to set the value of the highlighted digit of your Longitude.

8) Press Menu/Set to move to the next digit.

9) Repeat steps 7 and 8 until longitude has been entered to two decimal places.

10) Press Menu/Set to save your longitude.

Note: The flashing red LED will stop. Your required setup fields are complete.

You will now return to the Home screen

Setting the Cycle Time:

Important: The cycle times set how long you refrigerator stays off on Shabbos and Yom Tov vs. how long the refrigerator stays on.

We recommend testing each preset mode during the week for a minimum of 24 hours to see which works best for you and your refrigerator. During the 24 hour test period, monitor the food in refrigerator and freezer to determine which cycle works best.

	Green (accessible)	Red (no access)	Total cycle time (on and off)	Note: All cycles start at the top of the hour in order to give access at the beginning of each quarter hour or half hour throughout Shabbos and Yom Tov.
PRESET 1	3:25 Minutes	4:25 Minutes	7:30 minutes (2x in 15:00 min)	
PRESET 2	6:00 Minutes	9:00 Minutes	15:00 minutes	
PRESET 3	10:00 Minutes	20:00 Minutes	30:00 minutes	

***CAUTION:** Before pushing the refrigerator back into place; be sure to use the **PIN** feature to lock the device and to prevent accidental changes to the settings.

In the Setup  menu choose **PIN** On.

The PIN for every device is 9-1-9-1. The PIN cannot be changed.

Once the correct information is set, the Smart Control will automatically activate Shabbos/Yom Tov Operation each week.

