



**GE APPLIANCES**

CERTIFIED PRODUCT

---

# SHABBOS KEEPER USE & CARE GUIDE

---

*For use with approved GE Appliances Oven products.*

Refer to this quick start guide while setting up and using the Shabbos Keeper. Make sure to install the Shabbos Keeper at least 24 hours prior to the Sabbath. The Shabbos Keeper needs to be plugged into the oven at all times to ensure seamless operation. Be careful not to damage the Shabbos Keeper when moving or sliding the oven. Make sure to follow the included installation instructions carefully before setting up your Shabbos Keeper with this guide.

## SETUP INSTRUCTIONS

1. To ensure proper operation, the correct set-up information needs to be entered into the Shabbos Keeper before use. Use the up, down, left, right, and center buttons to navigate through the menus and make your selections at least 24 hours before the Sabbath.

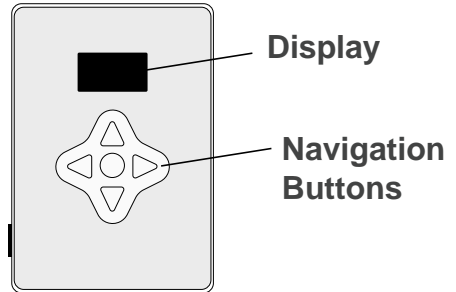

2. The first time your Shabbos Keeper is plugged in, it will communicate with the oven and check for enhanced Sabbath compatibility. Only compatible ovens can be used with the Shabbos Keeper. Ovens that are not compatible will show an error after a few minutes.

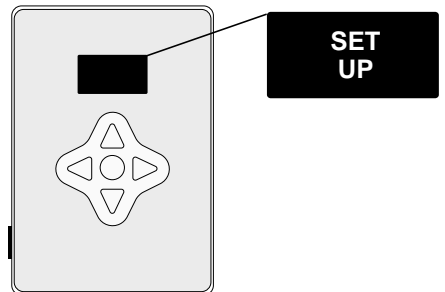

3. You will be prompted to enter the date, time, and location of the Shabbos Keeper. Use the left, right, up, and down keys to change the values and use the center button to confirm your selection.

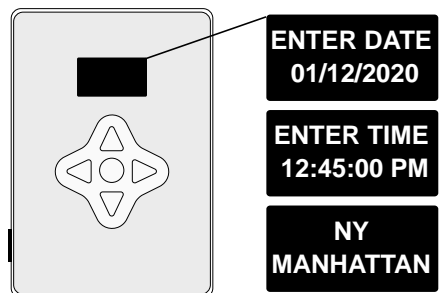

4. If your city or location is not listed, you can enter the coordinates of your location into the Shabbos Keeper along with your associated time zone.

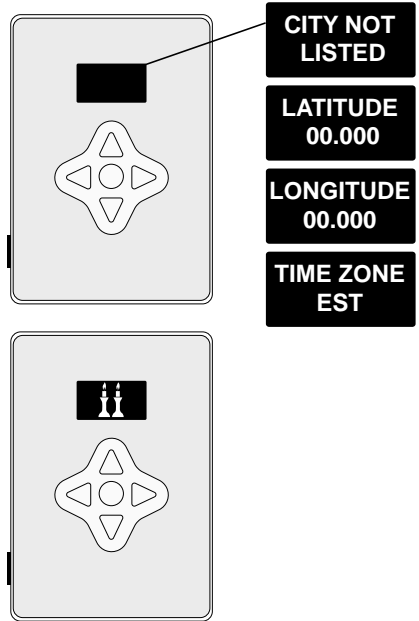

5. Setup is now complete. Make sure to keep your Shabbos Keeper in a proper storage location as described in the installation instructions. To adjust the time, date, or location parameters again, hold down the left and right arrow keys for 5 seconds to reset the device.

## SHABBOS MODE OPERATION

*Once your Shabbos Keeper is plugged in and set up, you are ready to begin using your oven during Sabbath.*

1. Four hours before each Sabbath, the oven display will prompt for the user to accept Shabbos Mode. Follow the steps below associated with your specific range type.

### Front Control & Rear Control Range Models:

Pressing the **“Start”** button on the range controls will set the oven to activate Shabbos Mode at Sunset. To accommodate early Sabbath, pressing Start + 9 will set the oven to activate Shabbos Mode at 90 minutes before sunset.

### Pro Style Range Models:

Pressing the **“Push To Select”** knob below the LCD will set the oven to activate Shabbos Mode at Sunset. For further functionality, you may rotate the same knob to cycle additional Sabbath options.

Note: Shabbos Keeper will always display two candles 90 minutes prior to sunset, even when starting Shabbos Mode at sunset.

**Steps continued on following pages**

# SHABBOS MODE OPERATION (CONT)

*Follow the steps below to assist in using the Shabbos Keeper with your specific range model*

---

**2.** After accepting the Shabbos prompt, you may use normal cooking modes (like bake, roast, etc.) up until Sabbath start (either sunset or 90 minutes early). At Sabbath start, your appliance will automatically enter Shabbos Mode .

**3.** Upon Shabbos Mode start, the oven by default will go into a 24 hour warming mode. If you would like to change how many hours your oven warms during Sabbath, you can select the keypad number that corresponds to the amount of warming hours from the table on the prior page. Modifications to the Shabbos Cycle must be made after accepting Shabbos Mode and prior to Shabbos Mode start. When choosing your selection, you will hear an audible beep that confirms your selection has been accepted.

**4.** Pressing the 9 Key within 90 minutes before sunset will start Shabbos Mode immediately. For Pro Style Range Models, pushing the “**Push To Select**” knob within 90 minutes before sunset will start Shabbos Mode immediately.

## SHABBOS MODE NOTES:

- If the user does not press the “**Start**” button, or for Pro Style Range Models, press the “**Push To Select**” knob, to accept the Shabbos Mode prompt, the Oven will enter the Shabbos Mode without any cooking at sunset.
- While the oven is observing the Shabbos Mode , opening and closing the door will have no impact on the appliance, and all buttons on the control will be disabled except for the “**Cancel**” button, or “ **Oven On/Off** ” button on Pro Style Range Models.
- Pressing the “**Cancel**” button, or “**Oven On/Off**” button on Pro Style Range Models, after accepting Shabbos Mode will terminate all current and future heating operations until Shabbos Mode has ended.

# SHABBOS MODE EXAMPLE ILLUSTRATIONS

Use the illustrations below to assist in using the Shabbos Keeper with your specific range model

## A. Front Control Range Models

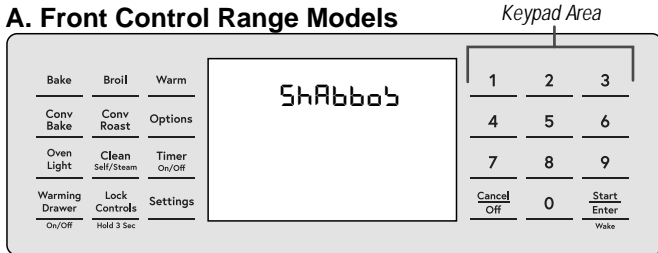

Keypad Number	Warming Hours
0	0
1	4
2	8
3	12
4	16
5	20
6	24
7	36
8	48

## B. Rear Control Range Models

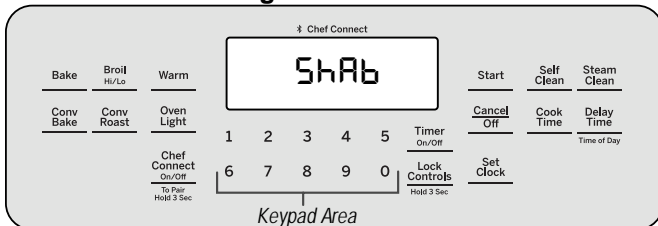

## C. Pro Style Range Models

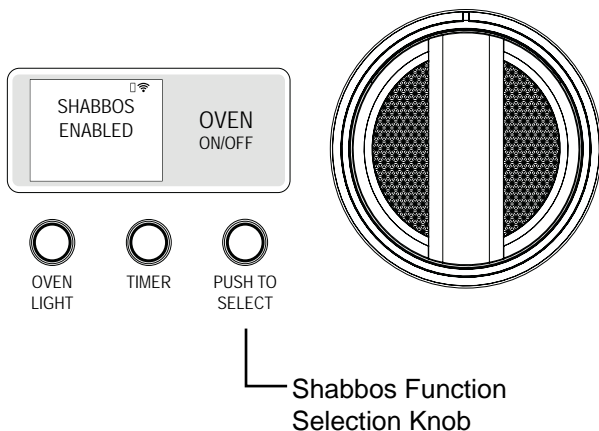

Early Shabbos Function:

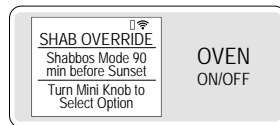

# HOLIDAY MODE OPERATION

*Holiday mode is a separate mode from Shabbos Mode for use on Yom Tov and other holidays. If a holiday coincides with the Sabbath, Shabbos Mode takes priority.*

**1.** Four hours before Yom Tov, the Shabbos Keeper will show a prompt on the oven display asking the user to accept Holiday mode. To accept, press the **“Start”** button on Front & Rear Control models, and the **“Push to Select”** knob on Pro Style Range Models.

**2.** Once accepted, at sundown your oven will automatically cycle between baking and warming cycles as described by the holiday schedule below:

---

## **Day 1:**

Bake 350F: From sunset until 4 hours later.

Warm: From 4 hours after sunset to 8am.

Bake 350F: From 8am to 12pm.

Warm: From 12pm to Sunset.

## **Day 2:**

Bake 350F: From sunset until 4 hours later.

Warm: From 4 hours after sunset to 8am.

Bake 350F: From 8am to 12pm.

Warm: From 12pm to Sunset plus 90 minutes.

**3.** By default, your oven will automatically go into the schedule listed above at sundown. If you would like to end the above schedule earlier, you can use the keypad, or control knob on Pro Style Range Models, to select Holiday modifications just like in Shabbos Mode. Refer to the following page for model specific examples:

## **HOLIDAY MODE NOTES:**

- If the user does not press the **“Start”** button, or **“Push to Select”** knob, to accept the Holiday Mode prompt, the Oven will enter the Holiday mode without any cooking at sunset.
- While the oven is observing the Holiday Mode, opening and closing the door will have no impact on the appliance and all buttons on the control will be disabled except for the **“Cancel”** button on Front and Rear Control models, and **“Oven On/Off”** on Pro Style Range Models.
- Pressing the **“Cancel”**, or **“Oven On/Off”** button after accepting Holiday Mode will terminate all current and future heating operations until Holiday Mode has ended.
- If you would like to enter Holiday Mode 90 minutes before sundown, you may press the **9** key on the number pad at any time up until 90 minutes before sundown. This will begin the holiday schedule 90 minutes early. For Pro Style Range Models, rotate the **“Push To Select”** knob and select the “90 minutes before sunset” option within the menu.
- If you would like to skip 350F baking cycles and only keep warm for the duration of the Holiday Mode, you may press the **0** key on the number pad at any time up until 90 minutes before sundown. This will skip the bake cycles in the holiday schedule. For Pro Style Range Models, rotate the “Push To Select” knob and select the “Keep Warm” option within the menu.

# HOLIDAY MODE EXAMPLE ILLUSTRATIONS

## A. Front & Rear Control Range Models

Keypad Number	Total Time
1	4
2	8
3	12
4	16
5	20
6	24
7	36
8	48

### Example

Four hours before sundown on Yom Tov, you decide that you only need to cook and keep warm for eight hours after sundown instead of the two-day default. Once you accept Holiday mode, you press the number 2 key on the number pad which corresponds to an 8 hour total heating time. This means that the oven will bake at 350F from sunset until four hours later and then keep warm for an additional four hours before turning off all heating features.

## B. Pro Style Range Models

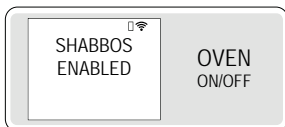

OVEN LIGHT



TIMER



PUSH TO SELECT

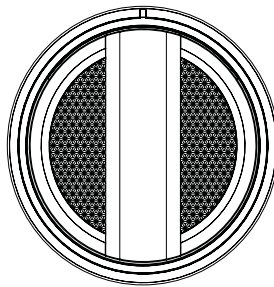

Additional Holiday Functions:

